

ORDER VESTING A SITE FOR A DWELLING

THE MAORI AFFAIRS ACT 1953

Section 440

IN THE MAORI LAND COURT

OF NEW ZEALAND.

Waiariki DISTRICT.

IN THE MATTER of
the piece of land
named Wharawhara 19B

AT a sitting of the Court held at Opotiki on the 11th
day of July 19 88 before Heta Kenneth Hingston, Esquire, Judge.

UPON HEARING the application of Kiwa Wharepapa
being a Maori or a descendant of a Maori and being ~~the sole owner of~~ the owner of an undivided interest
amounting to 56.76000 shares out of a total of 81.85000 shares in the piece of Maori
freehold/General land named Wharawhara 19B

IT IS HEREBY ORDERED that ~~the whole of the interest of the said owner/part~~ of the interest of the said
owner amounting to 3.40000 shares out of the said total shares in the said land be and the same is
hereby VESTED in Parehuia Wharepapa of 73 Goring Street,
and Opotiki his/her/wife/husband as sole owner/joint tenants/tenants in
~~common in equal shares~~ in order to provide him/her/them with a site for a dwelling.

AS WITNESS the hand of the Judge/Registrar/Deputy Registrar and the Seal of the Court



Registrar.

Deputy Registrar.

63 OPOTIKI MINUTE BOOK 174

At Opotiki - Mon 11 July 1988

Present - H K Hingston, Judge
R Waiapu, Clerk

72 WHARAWHARA 19A - s 440/53
73 WHARAWHARA 19B - "

Kiwa Wharepapa sworn:

Donees are my son and daughter respectively.
I realize value of gifts are \$4,000 and \$685 respectively -
I still wish to make gifts.

The donees both intend to build homes on blocks.

Order s 440/53 vesting all shares of donor in Tu Tiaki Wharepapa
in Wharawhara 19A.

Order s 440/53 vesting 3.4 shares of donor in Parehuia Wharepapa
in Wharawhara 19B.

76 TAWAROA TOPU - s 213/53

Present: Petihaukino Kerekere.

Eddie Matchitt for purchaser -

In 1985 price of shares \$25.99 per share - 1986 shares revalued
at \$2.04 - in 1987 \$11.13 - then was Board of Maori Affairs
I negotiated price at \$7.00 per share - I think is high because
of multiple ownership.

Ask for consideration that parties are first cousins - brother
and sister's children therefore price in circumstances adequate.

Court: In circumstances Order s 228/53 dispensing with special G.V.

Order s 213/53 vesting 1546.80 shares of Vendor in purchaser
subject to settlement with Maori Trustee within two months of
today - purchase price \$10,827 plus Stamp Duty plus Maori Trustee's
commission.

74 TAHORA 2A SEC 3B NO 3 - s 440/53

Mr Wiki Ihe:

Mrs Kiripa ill in Taupo - cannot attend.
Request adjournment to next Rotorua Court.

Court: Adjourned accordingly.
Notice to Mr Ihe.



Judge

M.A. 172 141A 12.6.87 (200)

Telegraphic Address: MAORIFAIRS



AppIn No 32081

Please quote this reference in your reply

MAORI LAND COURT

WAIARIKI DISTRICT

Government Buildings
Arawa Street
Telephone 82 189

Private Bag,
ROTORUA.

14.6.1988

Notice sent to:

Kiwa WHAREPAPA

P. Wharepapa.

73 Goring St

OPOTIKI

Dear Sir/Madam

APPLICATION SECTION 440/53

WHARAWHARA 198

BLOCK

The above application has been set down for hearing
at Whakatoka Maori Trust Board Rooms

Moody Place, Opotiki

Monday 11 July 1988 at 10.00 am/pm.

Yours faithfully

for Registrar

SEARCH SCHEDULE - MISCELLANEOUS APPLICATIONS

1. Name of land: WHARAWHARA 19B
2. Area: 2.4786 ha (6 Ac: 0r: 20p)
3. Nature and date of title order: Partition Order 19.6.56
4. Plan No. Sketch only District: V Haparapara S.D.
5. Is land on land transfer registry? no
6. If so, land transfer reference: -
7. Details of statutory restrictions (if any): -
8. Details of encumbrances or charges (if any): -
9. Details of alienations (if any): -
10. Sinking Fund (if any) as at / / \$ -
11. Government valuation as at 1 / 10 / 81 C.V. 16,500 L.V. 16,200 Imp: 300
12. Value of property other than land where land subject to Pt. IV/1967: -
13. Under what name or names is applicant/donor shown in the title? Kino Wharepapa
14. Total shares in block: 81.85000
15. Applicant's/donor's shares in block: 56.7600 Vesting Part Only 3.40000
16. Value of applicant's/donor's interest: \$ 11442.15 | \$685.40
17. Area of applicant's/donor's interest: 1.7188 ha | 10.29 m²
18. Amount of Sinking Fund affecting interest: \$ -
19. Other search data: (1) Donee not an owner
(2) 11 Owners

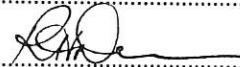

Searching Officer.

21.6.1988

NOTE - 1. This form is to be used for all Court searches except for those in respect of determination applications and exchange applications.
2. If information in addition to that required in 1-18 above is necessary to complete the search, enter under No. 19.

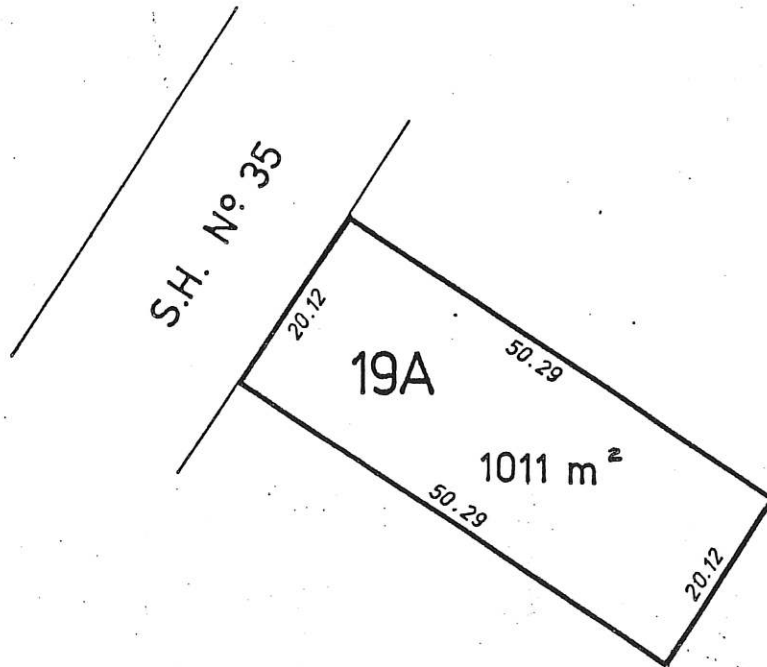
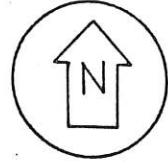

WHARAWHARA 19A BLOCK
Block V Haparapara Survey District

GISBORNE LAND DISTRICT, OPOTIKI COUNTY

Surveyed by A M Linton Aug. 1978

Scale 1 : 600

ML 6876

THE MAORI
M. O. O. O.
Judge
2.3.77

MEASUREMENTS ARE METRIC

R.M.P. Wf

1/4 acre worth

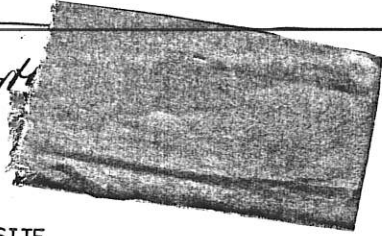

WP 1026C Disk 54C 10. 6.87 (300)

APPLICATION TO VEST A HOUSING SITE
The Maori Affairs Act 1953, section 440

In the Maori Land Court
of New Zealand
Waiariki District

Wharawhara 19B BLOCK

I, Kiwa Wharepapa
of 73 Goring St. Opotiki
(full address)

being the sole owner of (or the owner of an undivided share in) the above-mentioned block do hereby apply for an order under section 440 of the Maori Affairs Act 1953 vesting the whole of my interest in the said land (or part of my interest amounting to 3.40000 shares out of 56.76000 shares) in

Parehuia Wharepapa
of 73 Goring St. Opo.
(full address)

and NA his wife (the said being a Maori or

the descendant of a Maori) as joint tenants or as tenants in common in equal shares, for the purpose of providing him, her, ~~them~~ with a site for a dwelling.
Fee: \$20.00 + \$2.00 GST

SIGNED by the above-named as Applicant/) Applicant: K. Wharepapa.
Donor this 10th day of May)
1988 in the presence of:) Address: 73 Goring St.
Opotiki.
Witness: [Signature]
Capacity of Witness: Community Officer
Address: Dep't Maori Affairs
Opotiki

"ACCEPTED"

SIGNED by the above-named Donee this) Donee: [Signature]
10th day of May 1988 in)
the presence of:) Address: 73 GORING ST
OPOTIKI

Witness: [Signature]
Capacity of Witness: Community Officer
Address: Dep't Maori Affairs
Opotiki

Accept 8/10/88

NOTE: Persons qualified to act as a witness for both donor and donee are as follows:
~~Solicitor of the High Court, Justice of the Peace, Postmaster, Licensed Interpreter, Registrar or Deputy Registrar of the High Court or of the District Court or of the Maori Land Court, Assistant Director or a Community Officer of the Department of Maori Affairs.~~

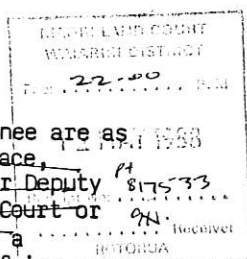

7 \$685 @ 1-10-81.

WHAKAPAPA TO BE ATTACHED TO SECTION 213, 440 AND 187 APPLICATIONS3 a FULL NAME(S) OF APPLICANT'S MOTHER

Miria TeArani WHAREPAPA (nee Rū)

b FULL NAMES OF MOTHER'S BROTHERS AND SISTERS (IF ANY)

Te Urupina Rū (f)

Te Materae Rū (f)

Teomoni Rū (f)

4 a FULL NAME(S) OF APPLICANT'S FATHER

Whitiarena Mahakore WHAREPAPA

b FULL NAMES OF FATHER'S BROTHERS AND SISTERS (IF ANY)

Pirita WHAREPAPA (m)

Hoooro " (m)

Mēne " (m)

Mare " (m)

Pine Titirangi (nee Wharepapa) (f)

Te Awhi Tanara (" " (f)

Maata Karikari (" " (f)

DATED this

10th

day of

May

1988

Applicant:

K. Wharepapa

Date:

10.5.1988